

HIDROSIB
S.A.



193rd Stefan Cel Mare str., 2400 Sibiu -Romania

400 l/min	Throttle valves NB 6 ... 32	FC - 16
Max 315 bar		

GENERALITIES

In-line mounting
With/without integrated by-pass valve
Manual regulation

PERFORMANCE DATA

GENERAL

Mounting position: unrestricted

Symbol:



Fluid flow direction:

A → B sau B → A

A → B droselizat
B → A liber

Temperature range of ambient medium: -20°C.....+50°C

HYDRAULIC

Nominal pressure : 315 bar

Nominal flow, at $V_{oil}=6m/s$

NB 6 10 16 20 25 32

10 l/min , 30 l/min, 65 l/min , 115l/min, 175 l/min, 250l/min

Maximal flow : conf Fig1 ...5

Cracking pressure of check valve :0,5 bar

Fluid :

Fluid type: additive mineral oil.

Viscosity range : 10 ...400mm²/s

Filtration: < 25 μm

CHARACTERISTIC CURVES

Pressure drop across throttle valve in completely open position vs flow rate, $\Delta P_{A-B} = f(Q)$

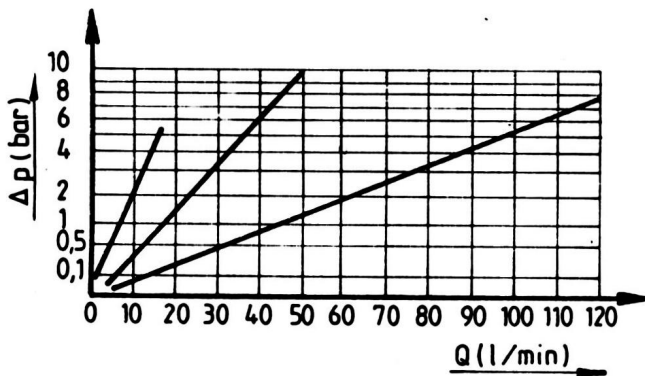

Fig. 1

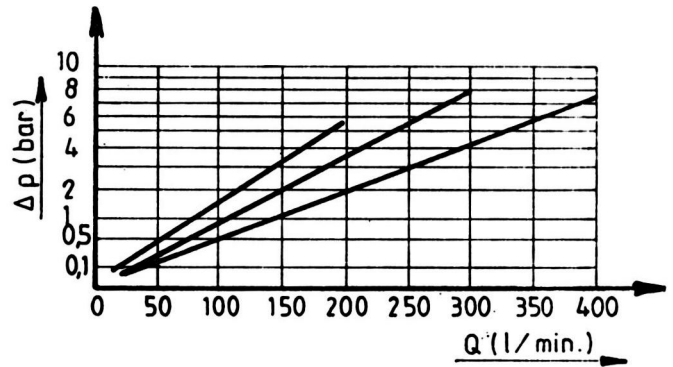

Fig. 2

Pressure drop across by-pass valve vs. flow rate : $\Delta P_{B-A} = f(Q)$

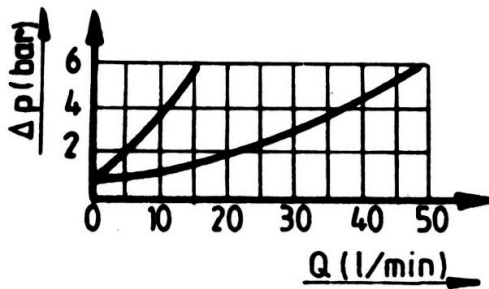

Fig. 3

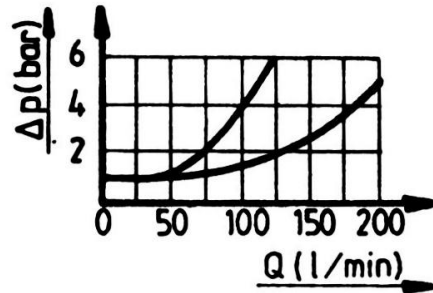

Fig. 4

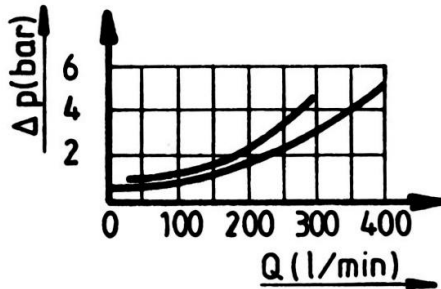

Fig. 5

DIMENSIONS

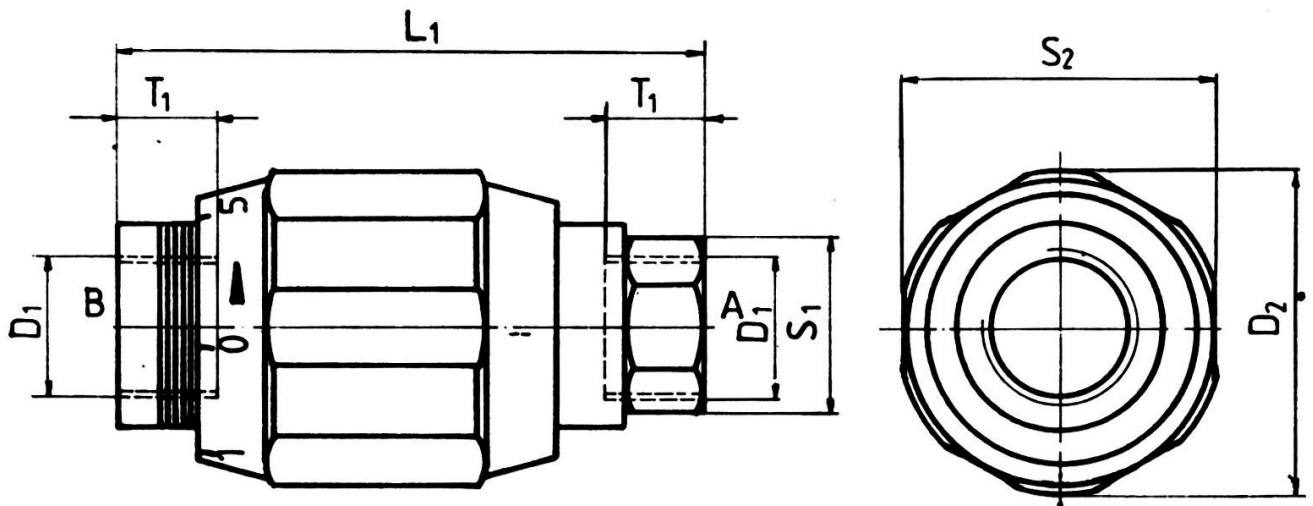

Fig. 6

Dn	D ₁	D ₂	L ₁	S ₁	S ₂	T ₁	Masa (kg)
6	M14 x 1,5	34	65	22	32	12	0,300
10	M 22 x 1,5	48	80	30	46	14	0,700
16	M27 x 2	58	100	41	55	17	1,200
20	M33 x 2	75	110	41	70	18	2,300
25	M42 x 2	85	130	55	75	20	3,500
32	M48 x 2	94	150	60	80	25	4,600

MODEL CODE

1 2 3 4-5-6

- 1. DR -Throttle valve
- 2. Integrated by-pass valve
 - 1 - with by-pass valve
 - 2 - without by-pass valve
- 3.T - in-line mounting
- 4. Nominal bore: 6/10/16/20/25/32
- 5. H - Manual regulation with non-adjustable wrench
- 6. O - Series